

20 INŠTALAČNÝ MATERIÁL

20.1 Inštalačný materiál

MOC bez DPH

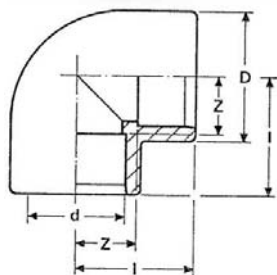

Koleno 90° na lepenie, PN 16

	D	
101016A	16	0,37
101020A	20	0,34
101025A	25	0,40
101032A	32	0,61
101040A	40	0,84
101050A	50	1,22
101063A	63	1,83
101075A	75	3,44
101090A	90	5,63
101110A	110	10,40
101125A	125	15,60
101140A	140	26,70
101160A	160	30,30
101200	200	45,70
101225	225	88,70
101250	250	176,00
101315	315	338,00

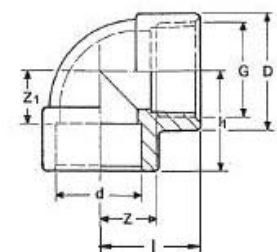

Koleno 90° na lepenie x vnútorný závit, PN 16

	D x G	
130016A	16 x 3/8"	1,55
130020A	20 x 1/2"	0,65
130025A	25 x 3/4"	0,95
130032A	32 x 1"	0,95
130040A	40 x 1 1/4"	1,24
130050A	50 x 1 1/2"	1,89
130063A	63 x 2"	2,54
130075	75 x 2 1/2"	13,90
130090	90 x 3"	20,90
130110	110 x 4"	32,10

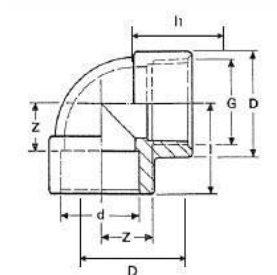

Koleno 90° na lepenie x vnútorný závit s výstužným krúžkom, PN 16

	D x G	
130016R	16 x 3/8"	2,70
130020R	20 x 1/2"	1,44
130025R	25 x 3/4"	1,68
130032R	32 x 1"	2,16
130040R	40 x 1 1/4"	2,66
130050R	50 x 1 1/2"	3,82
130063R	63 x 2"	5,04
130075R	75 x 2 1/2"	15,75
130090R	90 x 3"	23,80
130110R	110 x 4"	32,80

20.1 Inštalačný materiál

MOC bez DPH

Koleno 90° vnútorný závit, PN 16

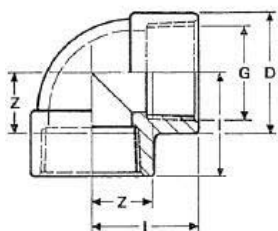

	G	
120020	1/2"	1,05
120025	3/4"	1,28
120032	1"	1,72
120040	1 1/4"	2,60
120050	1 1/2"	2,00
120063	2"	2,88
120075	2 1/2"	14,80
120090	3"	22,00
120110	4"	36,20

Koleno 90° na lepenie x vonkajšie lepenie, PN 16

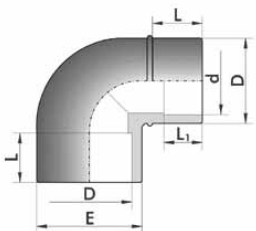

	D x d	
2.26.0110	40 x 32	1,55
2.26.0210	50 x 32	2,25
2.26.0310	50 x 40	2,55
2.26.0320	50 x 50/40	1,70
2.26.0420	63 x 63/50	2,50

Koleno 90° na lepenie x vonkajší závit, PN 16

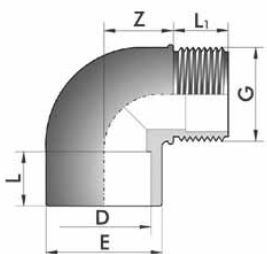

	D x G	
153325	32 x 3/4"	2,95
153332	32 x 1"	2,95
153340	32 x 1 1/4"	2,95
153440	40 x 1 1/4"	3,05
153450	40 x 1 1/2"	3,05
153540	50 x 1 1/1"	3,75
153550	50 x 1 1/2"	3,75
153563	50 x 2"	5,50
153663	63 x 2"	7,80

20.1 Inštalačný materiál

MOC bez DPH

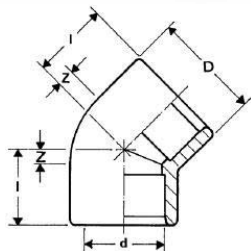

Koleno 45° na lepenie, PN 16

	D	
102016	16	0,47
102020A	20	0,44
102025A	25	0,55
102032A	32	0,74
102040A	40	0,99
102050A	50	1,28
102063A	63	1,93
102075A	75	3,68
102090A	90	5,63
102110A	110	9,51
102125A	125	14,00
102140	140	22,70
102160	160	26,80
102200	200	40,90
102225	225	80,30
102250	250	148,00
102315	315	281,00

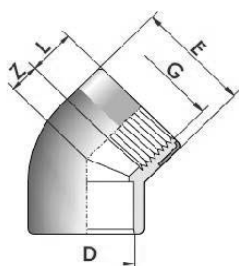

Koleno 45° na lepenie x vnútorný závit, PN 16

	D x G	
118016	16 x 3/8"	0,85
118020	20 x 1/2"	0,88
118025	25 x 3/4"	1,00
118032	32 x 1"	1,28
118040	40 x 1 1/4"	1,57
118050	50 x 1 1/2"	2,43
118063	63 x 2"	3,43
118075	75 x 2 1/2"	5,83
118090	90 x 3"	15,00
118110	110 x 4"	17,10

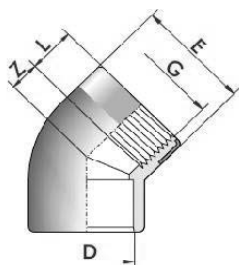

Koleno 45° na lepenie x vnútorný závit s výstužným krúžkom, PN 16

	D x G	
118020R	20 x 1/2"	1,65
118025R	25 x 3/4"	1,87
118032R	32 x 1"	2,35
118040R	40 x 1 1/4"	2,79
118050R	50 x 1 1/2"	4,11
118063A	63 x 2"	5,48

20.1 Inštalačný materiál

MOC bez DPH

Oblúk 90° na lepenie, PN 16

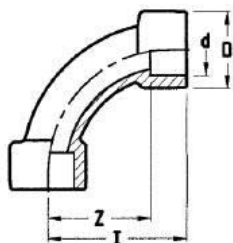

	D	
01969	32	2,07
01970	40	2,81
01971	50	2,96
01972	63	6,39
01973	75	8,38
05331	90	16,20
05332	110	28,60
05333	125	36,50
05334	140	57,30
05335	160	74,50
05336	200	140,00
05337	225	179,00
05338	250	226,00
05339	315	487,00

T-kus 90° na lepenie, PN 16

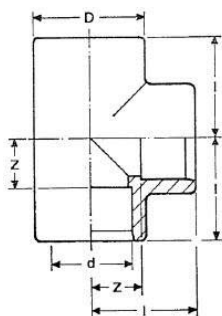

	D	
103016A	16	0,44
103020A	20	0,40
103025A	25	0,50
103032A	32	0,74
103040A	40	1,22
103050A	50	1,62
103063A	63	2,33
103075A	75	5,02
103090A	90	9,07
103110A	110	13,30
103125A	125	22,10
103140A	140	33,50
103160A	160	38,20
103200	200	57,10
103225	225	81,70
103250	250	186,00
103315	315	435,00

T-kus 90° na lepenie x vnútorný závit

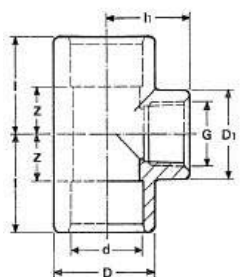

	D x G	
131016A	16 x 3/8"	0,65
131020A	20 x 1/2"	0,74
131220A	25 x 1/2"	1,40
131025A	25 x 3/4"	0,90
131032A	32 x 1"	1,07
131040A	40 x 1 1/4"	1,62
131050A	50 x 1 1/2"	2,39
131063A	63 x 2"	3,28
131075A	75 x 2 1/2"	14,70
131090	90 x 3"	17,90
131150	110 x 1 1/2"	36,20
131163	110 x 2"	36,20
131110	110 x 4"	30,10

20.1 Inštalačný materiál

MOC bez DPH

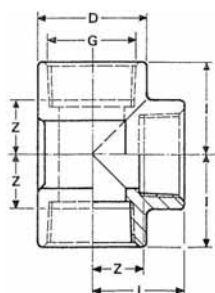

T-kus 90° vnútorný závit, PN 16

	G	
121020A	1/2"	1.66
121025A	3/4"	1.83
121032A	1"	2.23
121040A	1 1/4"	3.51
121050A	1 1/2"	4.83
121063A	2"	7.43
121075	2 1/2"	19.70
121090	3"	24.50
121110	4"	44.90

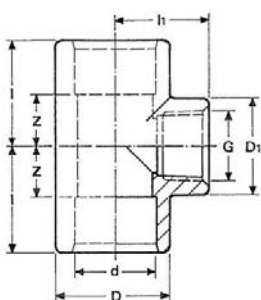

T-kus 90° na lepenie x vnútorný závit s výstužným krúžkom, PN 16

	D x G	
131020R	20 x 1/2"	1.64
131025R	25 x 3/4"	1.93
131032R	32 x 1"	2.38
131040R	40 x 1 1/4"	3.24
131050R	50 x 1 1/2"	4.49
131063R	63 x 2"	6.54

Potravný rozdeľovač vody na lepenie



3.91.0150	Rozdeľovač na lepenie 50	10.20
3.94.0155	Rozdeľovač na lepenie 50-63	11.20
3.94.0163	Rozdeľovač na lepenie 63	16.70

Potravný rozdeľovač vody priebežný s vnútorným závitom



3.94.0255	Rozdeľovač priebežný 2" x 1 1/2"	23.60
3.94.0263	Rozdeľovač priebežný 2" x 2"	25.00
3.94.0355	Rozdeľovač priebežný 2" x 1 1/2"	24.10

20.1 Inštalačný materiál

MOC bez DPH

T-kus 90° redukovaný na lepenie, PN 16

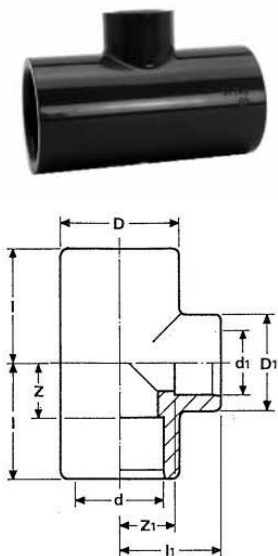

	D x D1	
104220A	25 x 20	0,88
104320A	32 x 20	1,24
104325A	32 x 25	1,24
104420A	40 x 20	2,50
104425A	40 x 25	2,50
104432A	40 x 32	1,68
104520A	50 x 20	2,18
104525A	50 x 25	2,18
104532A	50 x 32	2,18
104540A	50 x 40	2,18
104620A	63 x 20	3,60
104625A	63 x 25	3,60
104632A	63 x 32	2,86
104640A	63 x 40	2,94
104650A	63 x 50	4,89
104740	75 x 40	5,79
104750	75 x 50	5,79
104763	75 x 63	5,96
104940	90 x 40	10,40
104950	90 x 50	13,70
104963A	90 x 63	13,70
104975	90 x 75	13,70
104150	110 x 50	20,20
104163	110 x 63	20,20
104175	110 x 75	20,20
104190	110 x 90	20,20
104263	125 x 63	25,50
104275	125 x 75	25,50
104290	125 x 90	25,50
104210	125 x 110	25,50
104475	140 x 75	38,70
104490	140 x 90	38,70
104401	140 x 110	38,70
104402	140 x 125	38,70
104690	160 x 90	45,40
104610	160 x 110	45,40
104602	160 x 125	45,40
104604	160 x 140	45,40

T-kus 90° redukovaný na lepenie x vnútorný závit, PN 16

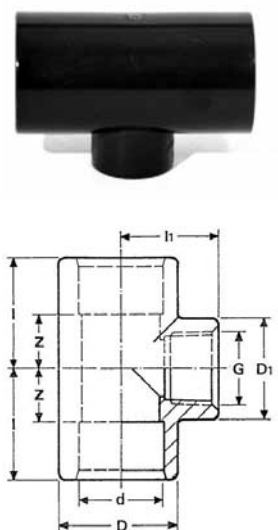

	D x G	
131220	25 x 1/2"	1,25
131320	32 x 1/2"	1,51
131325	32 x 3/4"	1,51
131420	40 x 1/2"	2,41
131425	40 x 3/4"	2,41
131432	40 x 1"	2,41
131520	50 x 1/2"	3,45
131525	50 x 3/4"	3,45
131532	50 x 1"	3,45
131540	50 x 1 1/4"	3,45
131620	63 x 1/2"	5,03
131625	63 x 3/4"	5,03
131632	63 x 1"	5,03
131640	63 x 1 1/4"	5,03
131650	63 x 1 1/2"	5,03
131732	75 x 1"	8,45
131740	75 x 1 1/4"	8,45
131750	75 x 1 1/2"	8,45
131763	75 x 2"	8,45
131940	90 x 1 1/4"	14,50
131950	90 x 1 1/2"	14,50
131963	90 x 2"	14,50
131975	90 x 2 1/2"	14,50
131150	110 x 1 1/2"	36,20
131163	110 x 2"	36,20

20.1 Inštalačný materiál

MOC bez DPH

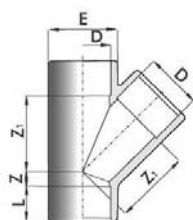

T-kus 45° na lepenie, PN 16

	D	
100020	20	2.04
100025	25	2.35
100032	32	2.63
100040	40	3.56
100050	50	3.74
100063	63	5.14
100075	75	18.05
100090	90	34.30

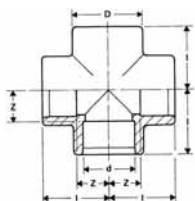

Križ 90° na lepenie, PN 16

	D	
107020	20	1.95
107025	25	1.95
107032	32	2.60
107040	40	4.16
107050	50	3.28
107063	63	4.66
107075	75	17.00
107090	90	35.30
107110	110	56.20

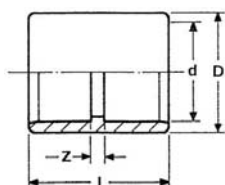

Spojka 90° na lepenie, PN 16

	D	
105016A	16	0.42
105020A	20	0.38
105025A	25	0.40
105032A	32	0.50
105040A	40	0.74
105050A	50	0.88
105063A	63	1.39
105075A	75	2.94
105090A	90	3.72
105110A	110	6.34
105125	125	9.56
105140	140	14.30
105160	160	18.80
105200	200	29.60
105225	225	49.40
105250	250	106.00
105315	315	149.00

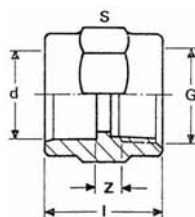

Mufňa na lepenie x vnútorný závit, PN 16

	D x G	
133016	16 x 3/8"	0.70
133020A	20 x 1/2"	0.61
133025A	25 x 3/4"	0.78
133032A	32 x 1"	0.84
133040A	40 x 1 1/4"	0.99
133050A	50 x 1 1/2"	1.22
133063A	63 x 2"	1.79
133075	75 x 2 1/2"	4.43
133090	90 x 3"	6.72
133110	110 x 4"	10.70

20.1 Inštalačný materiál

MOC bez DPH

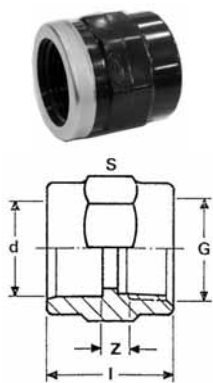

Mufňa na lepenie x závit s výstužným krúžkom, PN 16

	D x G	
133020R	20 x 1/2"	1,49
133025R	25 x 3/4"	1,68
133032R	32 x 1"	1,97
133040R	40 x 1 1/4"	2,41
133050R	50 x 1 1/2"	3,14
133063R	63 x 2"	4,16

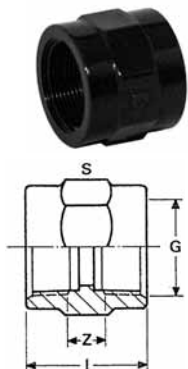

Mufňa s vnútorným závitom, PN 16

	G	
122016	3/8"	0,81
122020	1/2"	0,74
122025	3/4"	0,84
122032	1"	0,95
122040	1 1/4"	1,18
122050	1 1/2"	2,00
122063	2"	2,88
122075	2 1/2"	7,52
122090	3"	10,60
122110	4"	12,80

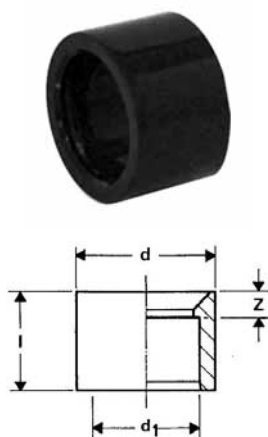

Redukcia na lepenie

	D x D1	
112116	20 x 16	0,27
112216	25 x 16	0,27
112220A	25 x 20	0,27
112320	32 x 20	0,29
112325A	32 x 25	0,29
112420	40 x 20	0,60
112425	40 x 25	0,48
112432A	40 x 32	0,44
112520	50 x 20	0,55
112525	50 x 25	0,55
112532	50 x 32	0,55
112540A	50 x 40	0,55
112632	63 x 32	1,04
112640	63 x 40	0,74
112650A	63 x 50	0,74
112740	75 x 40	1,65
112750	75 x 50	2,50
112763A	75 x 63	1,28
112950	90 x 50	2,62
112963	90 x 63	3,99
112975A	90 x 75	3,99
112050	110 x 50	6,83
112063	110 x 63	5,90
112075	110 x 75	5,90
112090A	110 x 90	4,05
112091	125 x 75	6,21
112092	125 x 90	6,59
112093A	125 x 110	6,09
112110	140 x 110	8,75
112125A	140 x 125	8,26
112002	160 x 110	12,10
112000	160 x 140	10,60
112001	200 x 160	18,60
112009	200 x 180	21,10
112004	225 x 160	27,80
112003	225 x 200	19,60
112006	250 x 200	40,40
112005	250 x 225	40,00
112008	315 x 225	127,00
112007	315 x 250	119,00
112415	400 x 315	158,00

20.1 Inštalačný materiál

MOC bez DPH



Prechodka

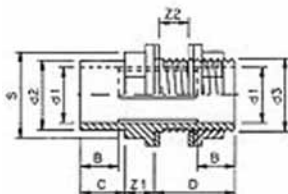

	D - D1 x G	
516 0200	20-25 x 3/4"	8.95
516 0250	25-32 x 1"	9.66
516 0340	32-40 x 1 1/4"	10.70
516 0410	40-50 x 1 3/4"	12.90
516 0480	50-63 x 2"	14.60
516 0500	50-63 x 2 1/4"	14.60
516 0650	63-75 x 2 1/2"	28.80
516 0750	75-90 x 3"	34.40
516 0900	90-110 x M113"	47.20
516 1100	110-125 x M133"	57.50



Úchytky na potrubie - otvorené

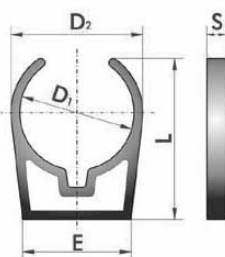

	D	
11 20 020	20	0.41
11 20 025	25	0.45
11 20 032	32	0.63
11 20 040	40	0.72
11 20 050	50	0.86
11 20 063	63	0.99
11 20 075	75	1.31
11 20 090	90	1.58
11 20 110	110	2.94
11 20 125	125	3.30
11 20 140	140	3.53
11 20 160	160	4.39
11 20 200	200	5.34
11 20 225	225	9.09



Úchytky na potrubie - uzavreté

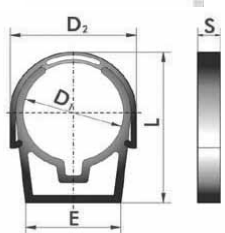

	D	
11 20 450	50	1.09
11 20 463	63	1.22
11 20 475	75	1.58
11 20 490	90	1.85
11 20 510	110	4.52
11 20 525	125	5.20
11 20 540	140	5.43
11 20 560	160	6.29
11 20 599	200	7.64
11 20 425	225	10.70



Prírubový nákrúžok na lepenie, PN 16

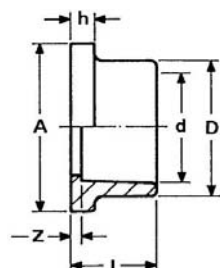

	D	
109020	20	0.56
109025	25	0.60
109032	32	0.69
109040	40	1.31
109050	50	1.95
109063	63	2.50
109075	75	3.51
109090	90	5.29
109110	110	4.16
109125	125	5.12
109140	140	7.73
109160	160	10.00
109200	200	18.90
109225	225	23.20
109250	250	57.90
109315	315	89.80

20.1 Inštalačný materiál

MOC bez DPH

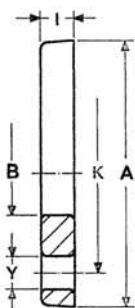

Príruba

	D	
110020	20	1,98
110025	25	2,15
110032	32	2,48
110040	40	3,06
110050	50	4,22
110063	63	4,79
110075	75	6,24
110090	90	6,68
110110	110	6,15
110125	125	9,07
110140	140	10,70
110160	160	12,20
110200	200	15,20
110225	225	17,00
110250	250	51,70
110315	315	78,60

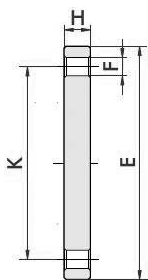

Slepá príruba

	D	
113020	20	6,20
113025	25	2,98
113032	32	4,01
113040	40	5,10
113050	50	6,29
113063	63	7,75
113075	75	10,20
113090	90	11,90
113110	110	15,50
113125	125	17,90
113140	140	21,10
113160	160	23,70
113200	200	34,40
113225	225	46,70
113250	250	73,00
113315	315	100,00

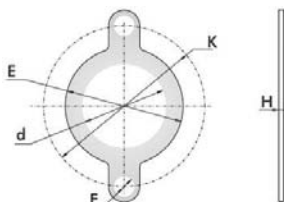

Ploché tesnenie

	D	
113020EVA	20	0,61
113025EVA	25	0,67
113032EVA	32	0,72
113040EVA	40	0,82
113050EVA	50	0,97
113063EVA	63	1,08
113075EVA	75	1,44
113090EVA	90	1,55
113110EVA	110	1,98
113125EVA	125	2,37
113140EVA	140	2,64
113160EVA	160	2,94
113200EVA	200	3,73
113225EVA	225	8,05
113250EVA	250	12,20
113315EVA	315	19,60

20.1 Inštalačný materiál

MOC bez DPH

Zátka na lepenie, PN 16

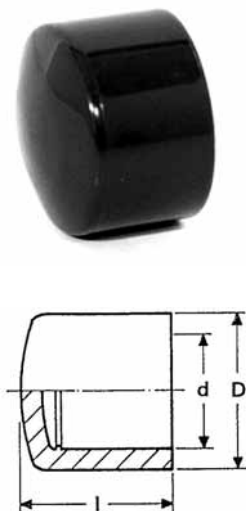

	D	
106016	16	0.31
106020A	20	0.34
106025A	25	0.34
106032A	32	0.48
106040A	40	0.71
106050A	50	0.95
106063A	63	1.32
106075A	75	2.63
106090A	90	4.07
106110A	110	8.72
106125A	125	11.90
106140	140	15.50
106160	160	17.30
106200	200	22.10
106225	225	45.10
106250	250	82.00
106315	315	198.00

Zátka s vnútorným závitom, PN 16

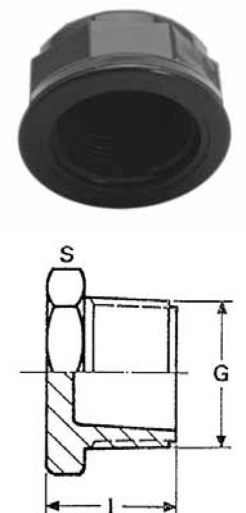

	G	
125016	3/8"	0.54
125020	1/2"	0.61
125025	3/4"	0.71
125032	1"	0.84
125040	1 1/4"	1.16
125050	1 1/2"	1.39
125063	2"	1.93
125075	2 1/2"	14.60
125090	3"	19.70
125110	4"	30.30

Zátka s vonkajším závitom, PN 16

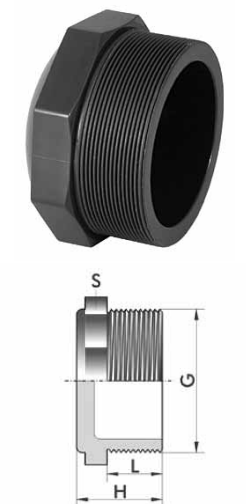

	G	
124012	1/4"	0.82
124016	3/8"	0.45
124020	1/2"	0.48
124025	3/4"	0.61
124032	1"	0.71
124040	1 1/4"	0.99
124050	1 1/2"	1.28
124063	2"	1.49
124075	2 1/2"	2.86
124090	3"	4.63
124110	4"	8.80

20.1 Inštalačný materiál

MOC bez DPH

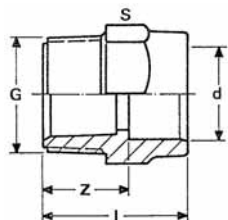

Prechodka na lepenie x vonkajší závit, PN 16

	D x G	
134020A	20 x 1/2"	0,71
134025A	25 x 3/4"	0,82
134032A	32 x 1"	0,95
134040A	40 x 1 1/4"	1,24
134051	50 x 1"	1,49
134050A	50 x 1 1/2"	1,49
134061	63 x 1"	2,33
134062	63 x 1 1/2"	2,33
134063A	63 x 2"	2,33
134075A	75 x 2 1/2"	3,30
134090A	90 x 3"	6,32
134110	110 x 4"	16,10

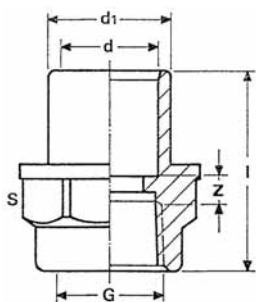

Redukcia na lepenie x na lepenie x vnútorný závit, PN 16

	D1 - D x G	
138216	20 - 16 x 1/4"	0,88
138217	20 - 16 x 3/8"	0,88
138218	20 - 16 x 1/2"	0,88
138219	20 - 16 x 3/4"	0,88
138220	25 - 20 x 1/2"	1,03
138221	25 - 20 x 3/4"	1,03
138222	25 - 20 x 1"	1,13
138325	32 - 25 x 1/2"	1,37
138326	32 - 25 x 3/4"	1,37
138327	32 - 25 x 1"	1,37
138328	32 - 25 x 1 1/4"	1,49
138432	40 - 32 x 1"	1,76
138433	40 - 32 x 1 1/4"	1,76
138434	40 - 32 x 1 1/2"	2,08
138540	50 - 40 x 2"	3,11
138541	50 - 40 x 1 1/4"	2,50
138542	50 - 40 x 1 1/2"	2,50
138650	63 - 50 x 2 1/2"	5,00
138651	63 - 50 x 1 1/2"	3,76
138652	63 - 50 x 2"	3,76
138763	75 - 63 x 2"	5,25
138764	75 - 63 x 2 1/2"	5,25
138765	75 - 63 x 3"	7,27
138975	90 - 75 x 2 1/2"	9,35
138976	90 - 75 x 3"	9,35
138977	90 - 75 x 4"	10,00
138190	110 - 90 x 3"	12,80
138199	110 - 90 x 4"	12,80

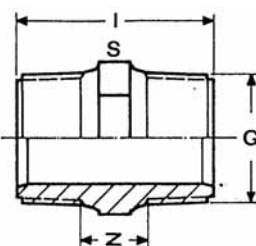

Nippel s vonkajším závitom, PN 16

	G	
123016	3/8"	0,98
123020	1/2"	0,55
123025	3/4"	0,74
123032	1"	0,78
123040	1 1/4"	1,01
123050	1 1/2"	1,45
123063	2"	2,23
123075	2 1/2"	6,42
123090	3"	8,76
123110	4"	13,60

20.1 Inštalačný materiál

MOC bez DPH

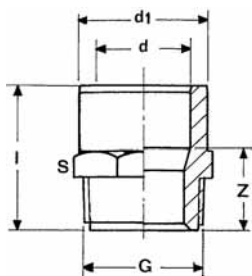

Redukcia na lepenie x na lepenie x vonkajší závit, PN 16

	D1 - D x G	
136001	16 - 12 x 3/8"	0,62
136003	20 - 16 x 3/8"	0,42
136002	20 - 16 x 1/2"	0,44
136004	25 - 20 x 1/2"	0,44
136029	25 - 20 x 3/8"	0,81
136005	25 - 20 x 3/4"	0,55
136030	32 - 25 x 1/2"	0,60
136007	32 - 25 x 3/4"	0,50
136008	32 - 25 x 1"	0,60
136009	40 - 32 x 3/4"	0,84
136010	40 - 32 x 1"	0,61
136011	40 - 32 x 1 1/4"	0,84
136012	50 - 40 x 1"	1,08
136013	50 - 40 x 1 1/4"	0,84
136014	50 - 40 x 1 1/2"	0,95
136015	63 - 50 x 1 1/4"	1,76
136016	63 - 50 x 1 1/2"	0,95
136017	63 - 50 x 2"	1,49
136018	75 - 63 x 1 1/2"	2,78
136019	75 - 63 x 2"	1,79
136020	75 - 63 x 2 1/2"	2,78
136021	90 - 75 x 2"	5,74
136022	90 - 75 x 2 1/2"	2,77
136023	90 - 75 x 3"	3,78
136024	110 - 90 x 2 1/2"	4,94
136025	110 - 90 x 3"	4,83
136026	110 - 90 x 4"	10,10
136031	125 x 110 x 2 1/2"	11,70
136027	125 x 110 x 3"	11,70
136028	125 x 110 x 4"	8,80

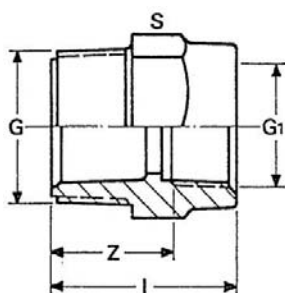

Redukcia vonkajší závit x vnútorný závit, PN 16

	G1 x G	
126116	3/8" x 1/2"	1,39
126225	1/2" x 3/4"	1,29
126216	1/2" x 3/8"	1,56
126232	3/4" x 1"	1,45
126220	3/4" x 1/2"	1,16
126162	3/4" x 3/8"	1,31
126340	1" x 1 1/4"	1,84
126325	1" x 3/4"	1,45
126320	1" x 1/2"	1,45
126450	1 1/4" x 1 1/2"	2,64
126432	1 1/4" x 1"	2,50
126425	1 1/4" x 3/4"	2,50
126420	1 1/4" x 1/2"	2,50
126563	1 1/2" x 2"	4,23
126540	1 1/2" x 1 1/4"	1,76
126532	1 1/2" x 1"	1,76
126520	1 1/2" x 1/2"	1,76
126525	1 1/2" x 3/4"	1,76
126632	2" x 1"	3,89
126640	2" x 1 1/4"	3,89
126650	2" x 1 1/2"	2,29
126625	2" x 3/4"	3,89
126675	2" x 2 1/2"	7,17
126763	2 1/2" x 2"	4,15
126790	2 1/2" x 3"	6,51
126963	3" x 2"	5,17
126975	3" x 2 1/2"	7,17
126910	3" x 4"	7,99
126090	4" x 3"	8,35

20.1 Inštalačný materiál

MOC bez DPH

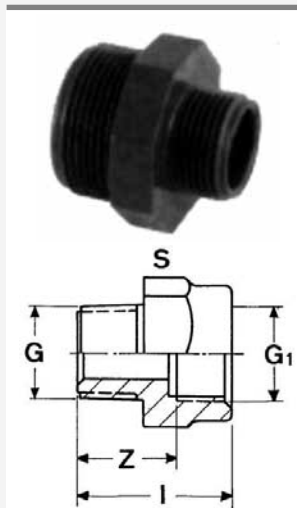

Závitová redukcia vonkajší závit x vonkajší závit, PN 16

	G x G1	
128216	1/2" x 3/8"	0,60
128201	3/4" x 3/8"	1,18
128220	3/4" x 1/2"	0,90
128316	1" x 3/8"	1,45
128320	1" x 1/2"	1,45
128325	1" x 3/4"	1,18
128420	1 1/4" x 1/2"	1,68
128425	1 1/4" x 3/4"	1,68
128432	1 1/4" x 1"	1,45
128525	1 1/2" x 3/4"	1,43
128532	1 1/2" x 1"	1,68
128540	1 1/2" x 1 1/4"	1,43
128632	2" x 1"	2,18
128640	2" x 1 1/4"	2,18
128650	2" x 1 1/2"	2,18
128763	2 1/2" x 2"	6,83
128975	3" x 2 1/2"	8,39
128090	4" x 3"	13,10

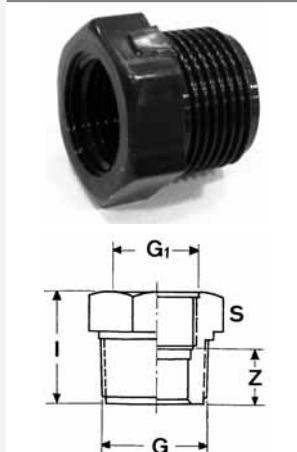

Redukcia krátka vonkajší závit x vnútorný závit, PN 16

	G1 x G	
129019	1/2" x 1/4"	0,93
129020	3/4" x 1/2"	1,16
129023	3/4" x 1/4"	1,80
129024	1" x 1/2"	1,01
129025	1" x 3/4"	1,33
129031	1" x 1/4"	1,35
129032	1 1/4" x 1"	1,64
129063	2" x 1 1/2"	2,82
129074	2 1/2" x 2"	3,82
129075	3" x 2 1/2"	6,51
129110	4" x 3"	15,50

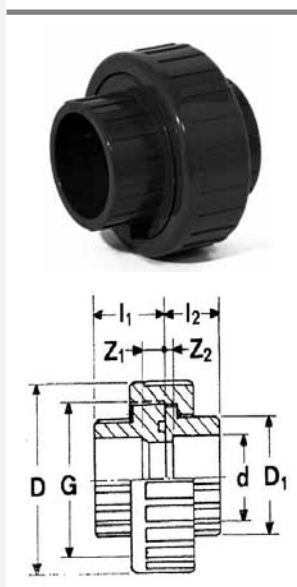

Šrobenie na lepenie, PN 16

	D	
108016	16	2,09
108020	20	1,34
108025	25	1,66
108032	32	2,37
108040	40	2,63
108050A	50	2,71
108063A	63	3,95
108075	75	13,60
108090	90	18,00
108110	110	25,30

20.1 Inštalačný materiál

MOC bez DPH

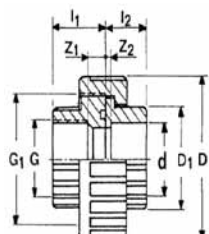

Šrobenie na lepenie x vnútorný závit, PN 16

	D x G	
132016	16 x 3/8"	2.69
132020	20 x 1/2"	1.89
132025	25 x 3/4"	2.18
132032	32 x 1"	2.94
132040	40 x 1 1/4"	3.28
132050A	50 x 1 1/2"	4.01
132063A	63 x 2"	5.84
132075	75 x 2 1/2"	15.60
132090	90 x 3"	21.00
132110	110 x 4"	28.60

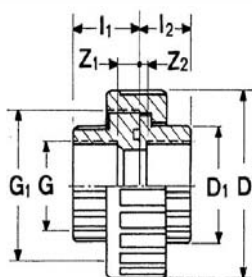

Šrobenie vnútorný závit x vnútorný závit

	G	
127016	3/8"	1.60
127020	1/2"	2.63
127025	3/4"	3.32
127032	1"	4.05
127040	1 1/4"	5.57
127050A	1 1/2"	4.77
127063A	2"	6.57
127075	2 1/2"	17.10
127090	3"	23.00
127110	4"	32.00

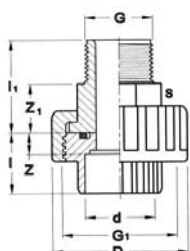

Šrobenie na lepenie x vonkajší závit, PN 16

	D x G	
115016	16 x 3/8"	3.04
115020	20 x 1/2"	1.45
115025	25 x 3/4"	1.72
115032	32 x 1"	2.18
115040	40 x 1 1/4"	2.44
115050A	50 x 1 1/2"	3.28
115063A	63 x 2"	4.77
115075	75 x 2 1/2"	28.70
115090	90 x 3"	40.50
115110	110 x 4"	51.70



Šrobenie na lepenie x mosadzný vonkajší závit

3.70.2020	PVC/mosadz 20 x 1/2"	12.40
3.70.2025	PVC/mosadz 25 x 3/4"	13.00
3.70.2032	PVC/mosadz 32 x 1"	16.80
3.70.2040	PVC/mosadz 40 x 1 1/4"	21.90
3.70.2050	PVC/mosadz 50 x 1 1/2"	28.00
3.70.2063	PVC/mosadz 63 x 2"	40.80
3.70.2075	PVC/mosadz 75 x 2 1/2"	95.10
3.70.2090	PVC/mosadz 90 x 3"	117.00

20.1 Inštalačný materiál

MOC bez DPH



Šrobenie na lepenie x mosadzný vnútorný závit

3.65.1200	PVC/mosadz 20 x 1/2"	11,30
3.65.1250	PVC/mosadz 25 x 3/4"	11,80
3.65.1320	PVC/mosadz 32 x 1"	14,70
3.65.1400	PVC/mosadz 40 x 1 1/4"	18,90
3.65.1500	PVC/mosadz 50 x 1 1/2"	24,00
3.65.1630	PVC/mosadz 63 x 2"	34,20
3.65.1750	PVC/mosadz 75 x 2 1/2"	79,80
3.65.1900	PVC/mosadz 90 x 3"	92,30

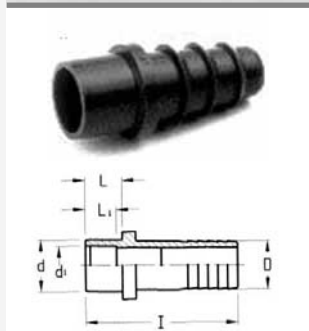

Hadivový trň, PN 16

	D	
116020	20	0,74
116025	25	0,88
116032	32	1,07
116040	40	1,72
116050	50	2,06
116063	63	2,29

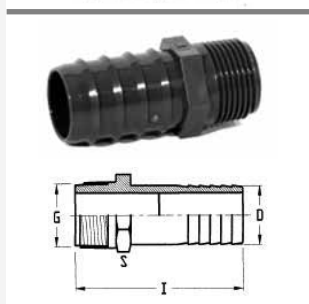

Hadivový trň s vonkajším závitom, PN 16

	G	
137020	1/2"	0,82
137025	3/4"	0,84
137032	1"	1,22
137040	1 1/4"	1,79
137050	1 1/2"	2,06
137063	2"	2,29



Hadivový trň kónický na lepenie, PN 16

	D	
116020C	20	0,74
116025C	25	0,88
116032C	32	1,07
116040C	40	1,68
116050C	50	1,93
116063C	63	2,29

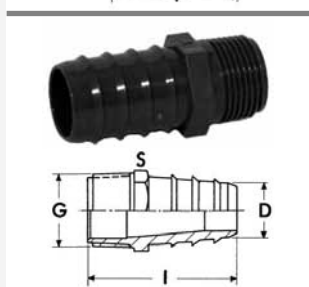

Hadivový trň kónický s vonkajším závitom, PN 16

	G	
137020C	1/2"	0,82
137025C	3/4"	0,84
137032C	1"	1,22
137040C	1 1/4"	1,79
137050C	1 1/2"	2,06
137063C	2"	2,29

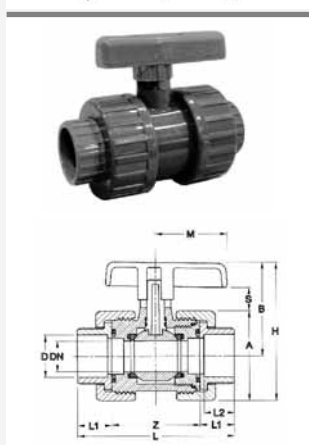

Guľový ventil na lepenie, PN 16

	D	
140020S	20	6,45
140025S	25	7,58
140032S	32	8,95
140040S	40	11,70
140050S	50	10,10
140063S	63	16,30

20.1 Inštalačný materiál

MOC bez DPH

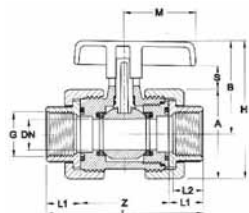

Guľový ventil s vnútorným závitom, PN 16

	G	
141020S	1/2"	5.80
141025S	3/4"	7.64
141032S	1"	8.82
141040S	1 1/4"	11.50
141050S	1 1/2"	13.90
141063S	2"	18.90

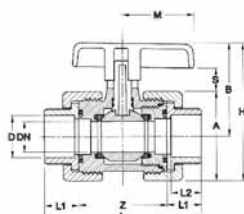

Guľový ventil uzatvárací, PN 16

	D	
140016	16	7.99
140075	75	89.80
140090	90	122.00
140110	110	178.00

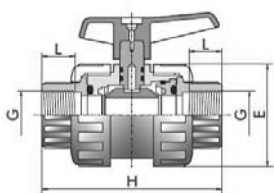

Guľový ventil uzatvárací s vnútorným závitom, PN 16

	G	
141016	3/8"	8.67
141075	2 1/2"	108.00
141090	3"	147.00
141110	4"	214.00



Guľový ventil trojcestný na lepenie

	D	
6.13.1016	T 16	19.60
6.13.1020	T 20	19.60
6.13.1025	T 25	24.10
6.13.1032	T 32	29.30
6.13.1040	T 40	37.30
6.13.1050	T 50	45.90
6.13.1063	T 63	55.00
6.13.5016	L 16	19.80
6.13.5020	L 20	19.80
6.13.5025	L 25	24.10
6.13.5032	L 32	29.30
6.13.5040	L 40	37.30
6.13.5050	L 50	45.90
6.13.5063	L 63	55.00

20.1 Inštalačný materiál

MOC bez DPH



Guľový ventil s elektropohonom 220 V

	D	
VE 6150 016	16	423,00
VE 6150 020	20	423,00
VE 6150 025	25	424,00
VE 6150 032	32	429,00
VE 6150 040	40	432,00
VE 6150 050	50	490,00
VE 6150 063	63	496,00
VE 6150 075	75	773,00
VE 6150 090	90	794,00
VE 6150 110	110	1 638,00
VE 6150 125	125	1 645,00



Guľový ventil trojcestný EPDM s elektropohonom 220 V

	D	
VE 6131 016	T 16	558,00
VE 6131 020	T 20	558,00
VE 6131 025	T 25	563,00
VE 6131 032	T 32	570,00
VE 6131 040	T 40	578,00
VE 6131 050	T 50	588,00
VE 6131 063	T 63	849,00
VE 6132 016	L 16	558,00
VE 6132 020	L 20	558,00
VE 6132 025	L 25	563,00
VE 6132 032	L 32	570,00
VE 6132 040	L 40	578,00
VE 6132 050	L 50	588,00
VE 6132 063	L 63	849,00



Spätná klapka, PN 16

	D	
164016	16	9,79
164020	20	6,20
164025	25	7,50
164032	32	8,13
164040	40	9,98
164050	50	12,50
164063	63	17,80
164075	75	45,20
164090	90	60,40
164110	110	67,00



Spätná klapka s vnútorným závitom, PN 16

	G	
165020	1/2"	6,05
165025	3/4"	7,88
165032	1"	8,69
165040	1 1/4"	11,70
165050	1 1/2"	12,80
165063	2"	18,80
165075	2 1/2"	77,50
165090	3"	102,00
165110	4"	119,00

20.1 Inštalačný materiál

MOC bez DPH

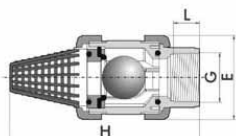

Spätňá klapka so sacím košom na lepenie

	D	
05 66 016	16	9,00
05 66 020	20	9,00
05 66 025	25	10,90
05 66 032	32	12,20
05 66 040	40	14,10
05 66 050	50	18,60
05 66 063	63	25,90
05 66 075	75	59,40
05 66 090	90	76,80
05 66 110	110	82,00

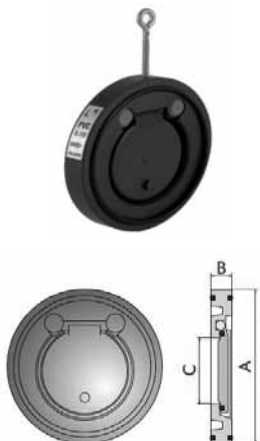

Spätňá klapka medzi prírubová, PN 16

	D	
168050	50	19,00
168063	63	22,50
168075	75	25,70
168090	90	30,50
168110	110	37,40
168125	125	40,10
168140	140	42,90
168160	160	52,60
168200	200	59,90
168225	225	62,30
168250	250/280	94,50
168315	315	142,00

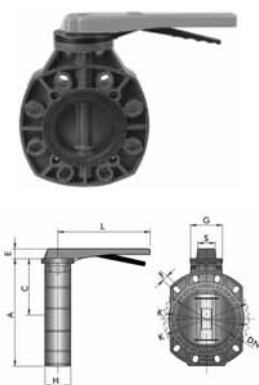

Uzatváracia klapka páková, PN 16

	D	
170075	63 - 75	78,70
170090	90	89,50
170110	110	98,50
170140	125 - 140	116,00
170160	160	134,00
170200	200 - 225	194,00
170250	250	372,00
170315	315	1 557,00

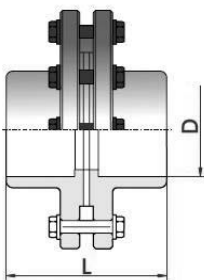

Prírubový komplet vr. skrutiek a tesnení, PN 16

	D	
172050	50	13,10
172063	63	19,10
172075	75	24,70
172090	90	30,30
172110	110	37,50
172125	125	48,40
172140	140	64,10
172160	160	77,50
172200	200	112,00
172225	225	115,00
172250	250	393,00
172315	315	457,00

20.1 Inštalačný materiál

MOC bez DPH



Spätná klapka medziprírubová s prírubovým kompletom na lepenie

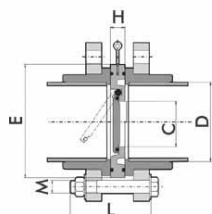

	D	
6.63.1050	50	40,70
6.63.1063	63	47,60
6.63.1075	75	53,70
6.63.1090	90	71,50
6.63.1110	110	88,20
6.63.1125	125	100,00
6.63.1140	140	120,00
6.63.1160	160	153,00
6.63.1200	200	188,00
6.63.1225	225	219,00
6.63.1250	250	614,00
6.63.1280	280	552,00
6.63.1315	315	783,00



Pákový uzatvárací ventil s prírubovým kompletom na lepenie

6.70.5063	63	86,70
6.70.5075	75	93,50
6.70.5090	90	131,00
6.70.5110	110	149,00
6.70.5125	125	175,00
6.70.5140	140	195,00
6.70.5160	160	259,00
6.70.5200	200	367,00
6.70.5225	225	367,00
6.70.5250	250	724,00
6.70.5315	315	2 352,00

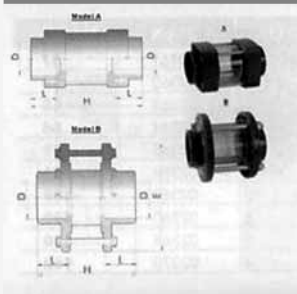

Priezor na kontrolu kvapalín (na lepenie)

	D	
05 54 050	50	15,60
05 54 063	63	19,30
05 54 075	75	50,40
05 54 090	90	61,00
05 54 110	110	75,70
05 54 125	125	89,10
05 54 140	140	110,00
05 54 160	160	160,00
05 54 200	200	185,00
05 54 225	225	228,00

20.1 Inštalačný materiál

MOC bez DPH

Navrtávací pas



	D x G	
202020	20 x 1/2"	0.90
202520	25 x 1/2"	0.90
202525	25 x 3/4"	0.90
203220	32 x 1/2"	1.26
203225	32 x 3/4"	1.26
203232	32 x 1"	1.26
204020	40 x 1/2"	1.39
204025	40 x 3/4"	1.39
204032	40 x 1"	1.39
205020	50 x 1/2"	1.58
205025	50 x 3/4"	1.58
205032	50 x 1"	1.58



206320	63 x 1/2"	2.08
206325	63 x 3/4"	2.08
206332	63 x 1"	2.25
206340	63 x 1 1/4"	2.25
206350	63 x 1 1/2"	2.48
207520	75 x 1/2"	3.42
207525	75 x 3/4"	3.42
207532	75 x 1"	3.42
207540	75 x 1 1/4"	3.42
207550	75 x 1 1/2"	3.42
207563	75 x 2"	3.42
209020	90 x 1/2"	4.37
209025	90 x 3/4"	4.37
209032	90 x 1"	4.37
209040	90 x 1 1/4"	4.37
209050	90 x 1 1/2"	4.37
209063	90 x 2"	4.37
201120	110 x 1/2"	5.04
201125	110 x 3/4"	5.04
201132	110 x 1"	5.04
201140	110 x 1 1/4"	5.04
201150	110 x 1 1/2"	5.04
201163	110 x 2"	5.04
201175	110 x 2 1/2"	5.04
201190	110 x 3"	6.49
201220	125 x 1/2"	9.22
201225	125 x 3/4"	9.22
201232	125 x 1"	9.22
201240	125 x 1 1/4"	9.22
201250	125 x 1 1/2"	9.22
201263	125 x 2"	9.22
201290	125 x 3"	10.50
201211	125 x 4"	11.30



201432	140 x 1"	10.80
201440	140 x 1 1/4"	10.80
201450	140 x 1 1/2"	10.80
201463	140 x 2"	10.80
201490	140 x 3"	13.70
201620	160 x 1/2"	15.20
201625	160 x 3/4"	15.20
201632	160 x 1"	15.20
201640	160 x 1 1/4"	15.20
201650	160 x 1 1/2"	15.20
201663	160 x 2"	15.20
201690	160 x 3"	17.80
201611	160 x 4"	17.80

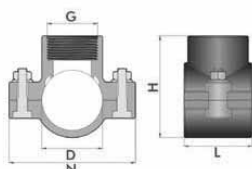

20.1 Inštalačný materiál

MOC bez DPH

Navrtávací pas zosilnený



	D x G	
212020	20 x 1/2"	1,45
212520	25 x 1/2"	1,45
212525	25 x 3/4"	1,45
213220	32 x 1/2"	1,66
213225	32 x 3/4"	1,66
213232	32 x 1"	1,66
214020	40 x 1/2"	1,89
214025	40 x 3/4"	1,89
214032	40 x 1"	1,89
215020	50 x 1/2"	2,12
215025	50 x 3/4"	2,12
215032	50 x 1"	2,12



216320	63 x 1/2"	2,12
216325	63 x 3/4"	3,11
216332	63 x 1"	3,28
216340	63 x 1 1/4"	3,28
216350	63 x 1 1/2"	3,55
217520	75 x 1/2"	4,68
217525	75 x 3/4"	4,68
217532	75 x 1"	4,68
217540	75 x 1 1/4"	4,68
217550	75 x 1 1/2"	4,68
217563	75 x 2"	4,68
219020	90 x 1/2"	6,22
219025	90 x 3/4"	6,22
219032	90 x 1"	6,22
219040	90 x 1 1/4"	6,22
219050	90 x 1 1/2"	6,22
219063	90 x 2"	6,22
211120	110 x 1/2"	7,25
211125	110 x 3/4"	7,25
211132	110 x 1"	7,25
211140	110 x 1 1/4"	7,25
211150	110 x 1 1/2"	7,25
211163	110 x 2"	7,25
211175	110 x 2 1/2"	7,25
211190	110 x 3"	8,78
211220	125 x 1/2"	11,20
211225	125 x 3/4"	11,20
211232	125 x 1"	11,00
211240	125 x 1 1/4"	11,20
211250	125 x 1 1/2"	11,20
211263	125 x 2"	11,20
211290	125 x 3"	13,20
211211	125 x 4"	13,50



211432	140 x 1"	13,50
211440	140 x 1 1/4"	13,50
211450	140 x 1 1/2"	13,50
211463	140 x 2"	13,50
211490	140 x 3"	13,50
211620	160 x 1/2"	17,10
211625	160 x 3/4"	19,20
211632	160 x 1"	19,20
211640	160 x 1 1/4"	19,20
211650	160 x 1 1/2"	19,20
211663	160 x 2"	19,20
211690	160 x 3"	25,90
211611	160 x 4"	25,90
212032	200 x 1"	57,00
212050	200 x 1 1/2"	57,00
212063	200 x 2"	57,00
212090	200 x 3"	69,40

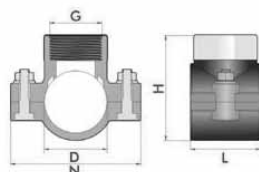

20.2 Tlakové hadice a PVC-rúry

MOC bez DPH



Tlakové hadice

	D	
082016	16	1,71
082020	20	1,79
082025	25	2,24
082032	32	2,62
082040	40	3,34
082052	50	3,15
082063	63	6,43
082075	75	9,35
082090	90	12,60
0820110	110	16,60

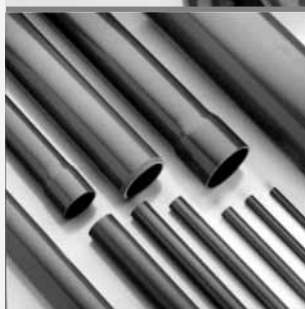

PVC rúry

	D	
191016	16, PN 16	0,59
191020	20, PN 16	0,76
191025	25, PN 16	1,18
191032	32, PN 10	1,23
191040	40, PN 10	1,59
191050	50, PN 10	2,13
191063	63, PN 10	3,66
191075	75, PN 10	5,23
191090	90, PN 10	7,48
191110	110, PN 10	9,04
191125	125, PN 10	11,60
191140	140, PN 10	14,90
191160	160, PN 10	18,00
191200	200, PN 10	30,10
191225	225, PN 10	37,80
191250	250, PN 10	46,80
191280	280, PN 10	58,30
191315	315, PN 10	73,90
191355	355, PN 10	93,80
191400	400, PN 10	118,00
196032	32, PN 16	1,62
196040	40, PN 16	2,50
196050	50, PN 16	3,82
196063	63, PN 16	4,91
196075	75, PN 16	7,81
196090	90, PN 16	11,20
196110	110, PN 16	13,70
196125	125, PN 16	17,40
196140	140, PN 16	22,20
196160	160, PN 16	28,90
196200	200, PN 16	45,10
196225	225, PN 16	57,20
196250	250, PN 16	70,10

Rúry PN 16 sú len na objednávku.

20.3 Lepidlá a príslušenstvo

MOC bez DPH

	Lepidlo TANGIT		
	182753	Lepidlo Tangit PVC-U, 125 g	5,29
	34949	Lepidlo Tangit PVC-U, 250 g	9,33
	298585	Lepidlo Tangit PVC-U, 500 g	16,80
	420286	Lepidlo Tangit PVC-U, 1 kg	25,70

	Čistič TANGIT		
	44589	Čistič Tangit, 125 ml	5,03
	44267	Čistič Tangit, 1000 ml	14,20

	Tesniace vlákno TANGIT	
	362843	Tesniace vlákno Tangit UNI-LOCK, 80 m

	Chemická kotva Pattex	
	874172	Chemická kotva Pattex CF 900 - vinylester, 300 ml

	Teflónová páska		
	0590500	Teflónová páska 12 mm/12 m	0,68
	0590550	Teflónová páska 19 mm/50 m	7,91

	FIX-A-LEAK	
	Prípravok pre utesnenie prasklín v bazéne a rozvodoch vody. Zacelí netesnosti do 5 mm. Vhodný pre všetky typy bazénov (nesmie sa dostať do filtračného zariadenia). Objem 1 liter.	
	25208	FIX-A-LEAK